



**MAP estate agents**  
Putting your home on the map

**Drump Road,  
Redruth**

**£190,000  
Freehold**







**Drump Road,  
Redruth**

**£190,000  
Freehold**

## **Property Introduction**

Situated close to the centre of town, this end terrace stone fronted house is being offered for sale chain free. Requiring a program of updating and modernisation, there are three bedrooms on the first floor and the ground floor offers a lounge, kitchen/dining room and a bathroom. The property has gas fired central heating and partial double glazing.

To the outside one will find an enclosed garden to the front with a driveway to the side which leads to the garage and gives parking for one vehicle. To the rear is an enclosed garden with steps up to the main garden which lies to the side and is largely laid to lawn and features a block built storage shed.

As stated, the property would benefit from some updating and modernisation and viewing our interactive virtual tour is strongly recommended prior to arranging a closer inspection.

## **Location**

Situated less than half a mile from the centre of town, schooling for younger children is within walking distance in the lower part of Drump Road and at the higher part one will find a late night convenience store. Redruth offers an eclectic mix of local and national shopping outlets, there is a mainline Railway Station which connects with London Paddington and the north of England and within three quarters of a mile one will find an out of town superstore at the bottom of Tolgus Hill.

Redruth is also home to Kresen Kernow which is a mecca for those researching their Cornish roots and the A30 trunk road will be found within three quarters of a mile. Truro, the county town of Cornwall, is within ten miles, Falmouth on the south coast which is Cornwall's university town is within eleven miles and Portreath on the north coast will be found within five miles.

### **ACCOMMODATION COMPRISES**

uPVC double glazed door opening to:-

### **HALLWAY**

Stairs to the first floor featuring storage cupboard beneath. Doors opening off to:-

### **LOUNGE 12' 6" x 12' 0" (3.81m x 3.65m)**

uPVC double glazed window to the front. Focusing on a brick fire surround with slate hearth (not used) and with an open beamed ceiling. Radiator.

### **INNER VESTIBULE**

Ceramic tiled floor, door to bathroom and doorway to:-

### **KITCHEN/DINER 12' 1" x 10' 3" (3.68m x 3.12m)**

Door to rear. Focusing on a floor to ceiling granite lintel fireplace (currently not in use) and with a ceramic tiled floor. Base unit with attached roll top edge working surface incorporating an inset stainless steel single drainer sink unit with hot and cold. Cooker point, tiled splashbacks and beamed ceiling. Wall mounted 'Worcester' gas combination boiler and radiator.

### **BATHROOM**

uPVC double glazed window to the rear and single glazed window to side. Fitted with a close coupled WC, pedestal wash hand basin and panelled bath with 'Triton' electric shower over. Extensive ceramic tiled splashbacks and radiator.

### **FIRST FLOOR LANDING**

A central landing with a storage cupboard and access off to:-

### **BEDROOM ONE 18' 6" x 11' 3" (5.63m x 3.43m) maximum overall measurements**

Two uPVC double glazed windows to the rear, recess suitable for wardrobe and radiator.

### **BEDROOM TWO 12' 3" x 8' 10" (3.73m x 2.69m)**

uPVC double glazed window to the front. Radiator.

### **BEDROOM THREE 9' 3" x 9' 0" (2.82m x 2.74m)**

uPVC double glazed window to the front. Over stairs storage shelf.

### **OUTSIDE FRONT**

To the front the garden is enclosed, laid to lawn with mature shrubs. To the side of the garden is a driveway giving additional parking if required and leading to the detached garage. Pedestrian access leads to the side of the property and it should be noted that a neighbouring property has access through here to the rear of their property.

### **REAR GARDEN**

The rear garden is enclosed and there is a storage shed. Access from here to the rear of the garage.

### **GARAGE 12' 11" x 9' 11" (3.93m x 3.02m)**

Up and over door to the front, the garage has been partially divided to create a:-

### **WORKSHOP AREA 9' 8" x 5' 10" (2.94m x 1.78m)**

uPVC double glazed window and door to rear. There is power, light and water connected.

### **SIDE GARDEN**

To the side there is the major part of the garden which is enclosed, lawned and features a range of mature shrubs and borders. There is access from here to a:-

### **BLOCK BUILT STORAGE SHED 11' 2" x 11' 1" (3.40m x 3.38m)**

### **AGENT'S NOTE**

Please be aware the Council Tax band for the property is band 'B'.

### **SERVICES**

Services connected include mains gas, mains electric, mains water and mains drainage.

### **DIRECTIONS**

From Redruth Railway Station proceed up the hill into Higher Fore Street, bear slight left into East End and take the first turning left into Drump Road. Continue down Drump Road and the property will be identified on the right hand side prior to the turning to Cardrew Way. If using What3words:- spots.euphoric.update



Energy Efficiency Rating		Current	Potential
Very energy efficient - lower running costs			
(92+)	A		
(81-91)	B		87
(69-80)	C		
(55-68)	D		
(39-54)	E	52	
(21-38)	F		
(1-20)	G		
Not energy efficient - higher running costs			
England & Wales		EU Directive 2002/91/EC	



## MAP's top reasons to view this home

- Stone fronted end terrace house
- Three bedrooms
- 12' Lounge
- 12' Kitchen/dining room
- Ground floor bathroom
- Gas central heating
- Partial double glazing
- Gardens, garage and workshop
- Chain free sale
- Requires some updating

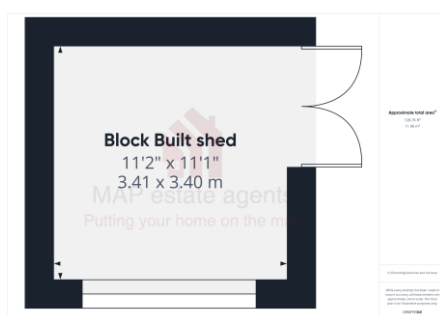
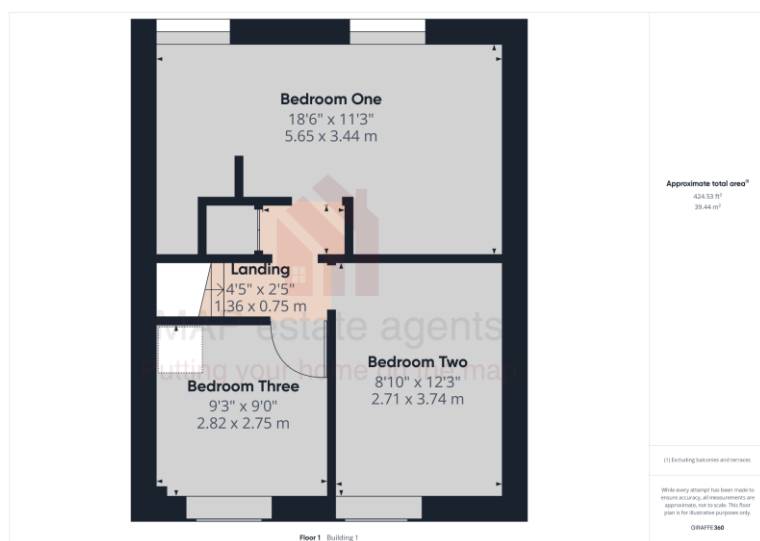

[sales@mapestategents.com](mailto:sales@mapestategents.com)

Gateway Business Park, Barncoose  
Cornwall TR15 3RQ

[www.mapestategents.com](http://www.mapestategents.com)

01209 243333 (Redruth & Camborne)

01736 322200 (St Ives & Hayle)

01326 702400 (Helston & Lizard Peninsula)

01736 322400 (Penzance & surrounds)

01326 702333 (Falmouth & Penryn)

01872 672250 (Truro)

**IMPORTANT:** Map estate agents for themselves and for the vendors or lessors of this property whose agents they are give notice that the particulars are produced in good faith and are set out as a general guide only and do not constitute any part of a contract and no person in the employment of Map estate agents has any authority to make or give any representation or warranty in relation to this property.